

Neptune WTA Series Whole House Ultraviolet System



Neptune WTA Residential Systems

- Ensures safe water throughout the whole house.
- UV-C energy inactivates pathogens without adding anything to water—no aftertaste, no chemicals, and no harmful by-products, helping protect not only your clients' health but also the environment.
- Simple in design, the WTA Series does the job without a lot of costly add-ons and expensive replacement parts, making it a smart choice.

Key Benefits

- ◆ Clean, chemical free and environmentally friendly
- ◆ Safeguards water with proven and effective microbiological protection
- ◆ 304 stainless steel disinfection chamber with heavy duty mounting brackets
- ◆ Horizontal or vertical mounting
- ◆ High quality American Made Standard Output UV Lamp provides continuous UV output throughout the total lamp life (approximately 9,000 hours)
- ◆ Simplified installation and maintenance with low operational cost

Improved Features

- ◆ Upgraded high efficiency electronic ballast with built-in monitoring functions
- ◆ Visual display with lamp life timer and runtime meter (Deluxe Models)
- ◆ LED lamp status indicator
- ◆ LED alarm status indicator with audible alarm upon lamp failure
- ◆ 365-Day countdown timer and holder with audible alert (Standard Models)



Standard Power Supply
120V 60Hz



Deluxe Electronic Ballast
110-240V 50/60Hz



**Water Treatment
& Accessories, LLC**
"The Ultraviolet Specialist"

| Model Specifications | | | | |
|--|-----------|-------------------------------|------------------|------------------|
| Model # | WTA-4 | WTA-7 WTA-7P | WTA-10 | WTA-15 |
| Inlet/Outlet Size | 1/2" MPT | 3/4" MPT | 3/4" MPT | 1" MPT |
| Operating Voltage | 120V 60Hz | 120V 60Hz 110-240V 50/60Hz | 110-240V 50/60Hz | 110-240V 50/60Hz |
| *Flow Rate 40mJ/cm ² | 2 GPM | 3.5 GPM | 5 GPM | 8 GPM |
| *Flow Rate 30mJ/cm ² | 2.5 GPM | 5 GPM | 8 GPM | 11 GPM |
| *Flow Rate 16mJ/cm ² | 4 GPM | 7 GPM | 12 GPM | 16 GPM |
| *Flow rate based on UV dosage at end of lamp life (9,000 hours—approximately 1 year) | | | | |
| Model Dimensions | | | | |
| Dimensions A | 10.23" | 17.32" | 23" | 31.50" |
| Dimensions B | 16.40" | 23.25" | 29" | 38.05" |
| *Dimensions C | 4" | 4" | 4" | 4" |
| Dimensions D | 2.5" | 2.5" | 2.5" | 2.5" |
| * (C) Dimensions may vary slightly depending on Inlet/Outlet connection size | | | | |

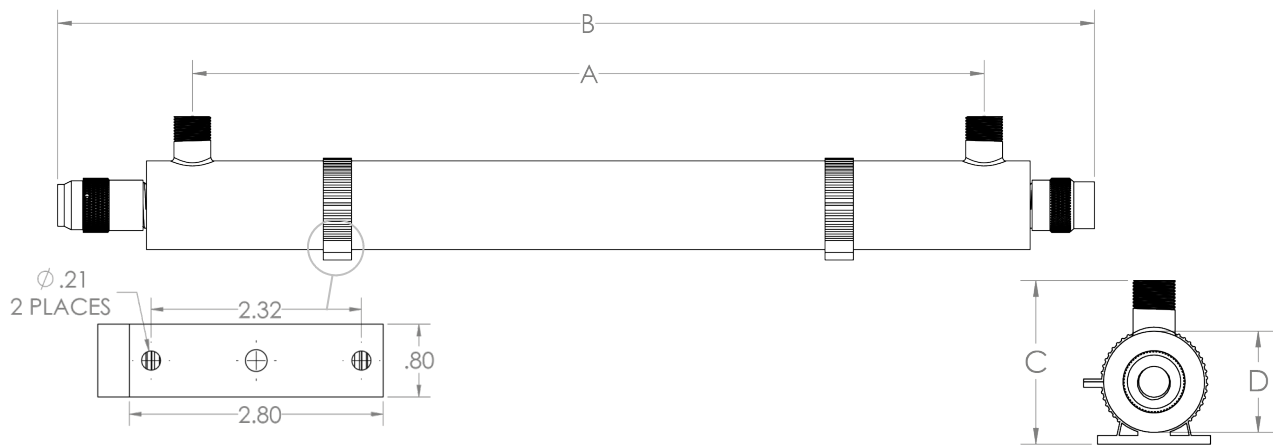

Standard Models

WTA-4, WTA-7—

Includes a viewport, countdown timer and standard power supply equipped with an LED lamp status indicator and audible alarm



Deluxe Models

WTA-7P, WTA-10, WTA-15—

Includes a viewport and deluxe power supply equipped with an LED lamp status indicator, runtime meter and audible alarm



490 Historic Drive
PO Box 295
Strasburg, PA 17579
Phone: (717) 295-9339
Fax: (717) 396-0364
info@uvwatertreatment.com
www.uvwatertreatment.com